

Outstanding Items Report – 11/04/2020

Project: Niles Barnard Renovation Project
Project No: 0128-18-0020
Date: November 4, 2020

Owner: City of Troy

1. Items from 2020-03-18 Site Observation Report: Verification Photo:
 - a. Existing beam left unsupported at end. Provide beam hanger by Simpson Strong-Tie or KantSag to attach existing timber beam to new double LVL beam w/ beam hanger. (Labeled as "D" in photo below)
- Completed date: 2020 - - Verified by:





- b. Refer to details 7/A-211 and 8/A-211 (attached) for correct installation of sheathing
Completed date: 2020 - - **Verified by:**
2020-08-26: Unable to verify due to installation of gypsum board in affected areas, no verification photo provided by Cedroni.

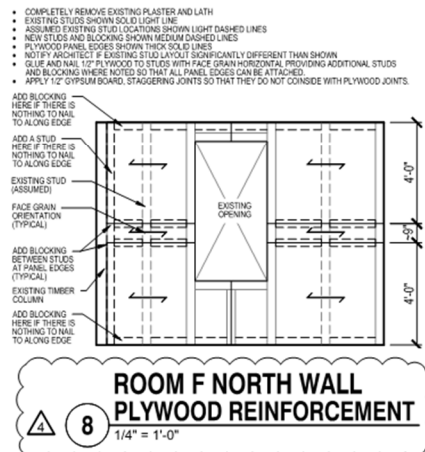
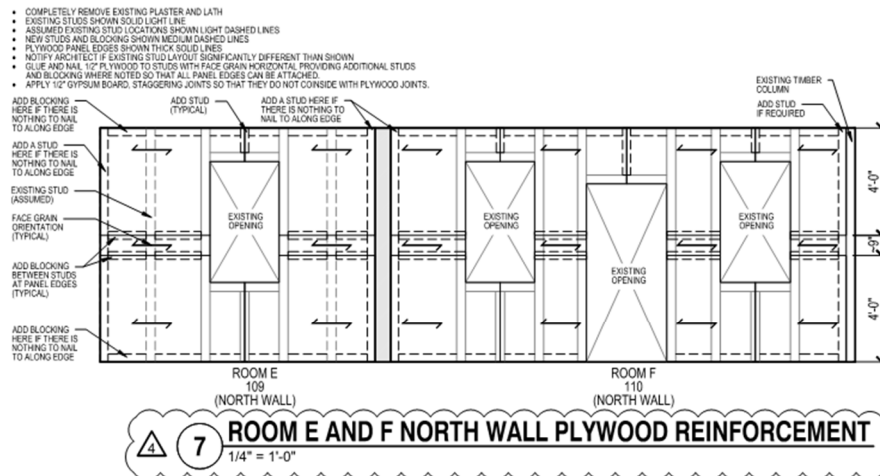



2. Items from 2020-05-21 Site Observation Report:

- a. Existing siding on northwest corner of existing building to be replaced with salvaged original siding and trim. (Photos below)

Completed date: 2020 - - Verified by:



3. Items from 2020-07-01 Electrical Engineers Site Observation Report

- a. Prepare surface of steel exposed during the course of welding and paint with rust inhibitive primer per specifications on sheet S0-1

Completed date: 2020 - - Verified by:





4. Items from 2020-08-19 Site Visit

- a. LVL carrying stringer cracked at fastener locations, rotating under load.
Provide full height 2x full height, glue and screw to existing 2x and LVL, attach to blocking above at condition shown and similar at center of stair bearing location.

Completed date: 2020 -

-

Verified by



provide 2x full height, glue and screw to existing 2x and LVL, att to blocking above.

2020-08-26: Partially complete, provide similar at center of stair bearing location as noted above.

2020-09-02: Unable to verify due to affected area covered with gypsum board, no verification photo provided by Cedroni

2020-08-26 Verification





2020-09-02 Unable to verify due to gypsum board enclosure, no verification photo provided.





5. Items from 2020-10-07 Site Visit

- a. Base cabinets in Room D (113) do not have plastic laminate bases per shop drawing markups.



CABINET BODY:	
CONSTRUCTION STYLE	FULL OVERLAY
JOINERY	10mm DOWEL
1 BACKS AT OPEN/GLASS DOOR CABINETS	1/4" INSET BACKS - HORIZONTAL GRADE LAMINATE 0.039 - 0.048 (± 0.005)
NAILERS AT OPEN/GLASS DOOR CABINETS	3/4" NAF PB, 4" WIDE RAILS, 2 @ BASE & WALL CABINETS, 3 MIN. @ TALLS
2 BACKS AT CLOSED CABINETS	1/4" INSET BACKS - THERMALLY FUSED LAMINATE
NAILERS AT CLOSED CABINETS	3/4" NAF PB, 4" WIDE RAILS, 2 @ BASE & WALL CABINETS, 3 MIN. @ TALLS
3 SUBTOPS	FULL DEPTH SUBTOP
INTERMEDIATE RAILS	NOT REQUIRED
SECURITY PANELS	NOT REQUIRED
4 SUBBASE	3/4" PLYWOOD (13mm RECESS AT FINISHED ENDS) p.lam finish
5 CABINET CORE MATERIAL	3/4" NAF PB
6 BODY FRONT EDGES	1mm PVC
7 INTERIOR OF OPEN/GLASS DOOR CABINETS	HORIZONTAL GRADE LAMINATE 0.039 - 0.048 (± 0.005)
8 INTERIOR OF CLOSED CABINET	THERMALLY FUSED LAMINATE
9 FINISHED SIDES	HORIZONTAL GRADE LAMINATE 0.039 - 0.048 (± 0.005)
10 WALL CABINET BOTTOMS	HORIZONTAL GRADE LAMINATE 0.039 - 0.048 (± 0.005)
11 WALL CABINET BOTTOM EDGES	1mm PVC
COLOR REQUIREMENTS	COLOR TO MATCH WALL BOTTOM (IF UNAVAILABLE, WILL MATCH BODY EDGE)
12 WALL/TALL CABINET TOP EDGES	NOT EDGED
EDGE REQUIREMENTS	INCLUDED AT CABINETS LESS THAN 80" HIGH
COLOR REQUIREMENTS	COLOR TO MATCH CABINET TOP (IF UNAVAILABLE, WILL MATCH BODY EDGE)
13 FACE EDGES	3mm PVC
14 FACE INTERIOR SURFACES	HORIZONTAL GRADE LAMINATE 0.039 - 0.048 (± 0.005) TO MATCH FACE EXTERIOR COLOR
15 FACE EXTERIOR SURFACES	HORIZONTAL GRADE LAMINATE 0.039 - 0.048 (± 0.005)
FILLER STYLE	FLUSH WITH CABINET BODY

(Page 7 of Submittal 011 – 12 32 16 – Casework, approved as noted 2020/03/06)

Completed date:2020 - - Verified by:









6. Items from 2020-10-21 Site Visit

- a. **CUH below display window black with aluminum trim; Replace trim kit with Bronze**
Completed date:2020 - - Verified by:



Color Code Chart

Code	Color		Code	Color	
BZ		Bronze	W		White
AE		Metallic Silver	A		Almond
CM		Metallic Charcoal	AL		Aluminum
BK		Semi-gloss black			



b. Address water intrusion at threshold of door 103A

Completed date: 2020 - 11 - 04 Verified by: V. Verna



Verification Photo – Gasketing added to bottom of door.





7. Items from 2020-11-04 Site Visit

- a. Nail removal and painting needed at building and columns where existing railing removed from porch at door 101A**

Completed date:2020 - - Verified by:





- b. Trim installation at door 114A differs from elevation supplied as part of “Submittal 016-R02 – 08 14 00 – Door 114A” Based on site discussion between architect, contractor and THV replace the siding above the door with 5/4 hardi-trim. Other trim may remain in place.

Completed date:2020 - - Verified by:

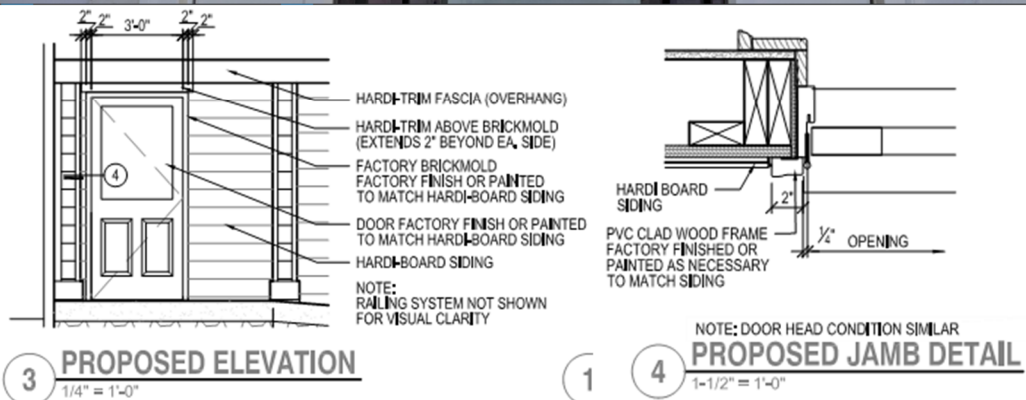



- c. **Crawlspace hatch difficult to install, linoleum overhangs hatch panel and is peeling from surface of panel. Chamfer edge of hatch panel as sketched below, trim linoleum flooring to extents of panel, install specified opening hardware.**

Completed date: 2020 - - Verified by:

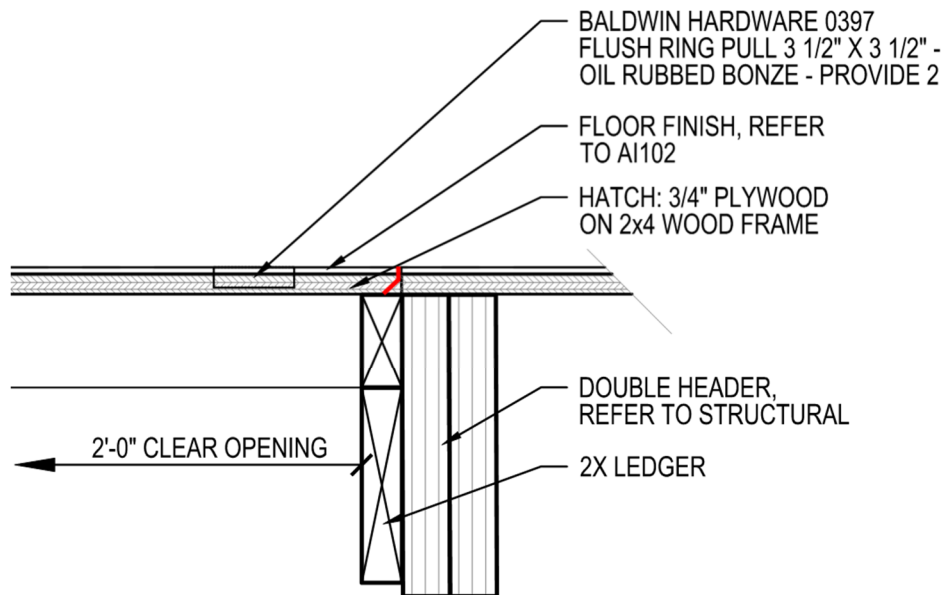

8 ACCESS HATCH DETAIL

1-1/2" - 1'-0"

END OF ARCHITECT'S OUTSTANDING ITEMS REPORT

Prepared and Submitted By:

Vincent Verna
cc: File