

## **BULLETIN NO. 2**

DATE ISSUED: September 18, 2017

PROJECT NUMBER: HCMA # 509-16-532  
AEW # 0215-0038

PROJECT: STONY CREEK LANDING

OWNER: Huron-Clinton Metropolitan Authority (HCMA)  
13000 High Ridge Drive  
Brighton, Michigan 48114

CONTRACTOR: Cedroni Associates Inc.  
5639 Auburn Road  
Utica, Michigan 48317

ARCHITECT/ENGINEER: Anderson, Eckstein and Westrick, Inc.  
51301 Schoenherr Road  
Shelby Township, Michigan 48315

### **CONTENTS OF BULLETIN NO. 2:**

1. After Owner review, the following modifications and/or clarifications have been made to the Contract Drawings:
  - a. Sheet No. C9, Paving & Grading Plan – Finished Grade elevations were revised to match the finish floor elevations on the southwest, southeast and northeast sides of the Stony Landing Building.
  - b. Sheet No. E0, Electrical Site Plan – A Bollard Base Plate Bolt Pattern Detail and a Bollard Footing Detail were supplied for the Arroch Granite 70 Round Outdoor Bollard.

**END OF BULLETIN**

BENCH MARK No. 1  
SANITARY MANHOLE RIM,  
75'± EAST OF EX. TENT.  
ELEVATION: 813.39

BENCH MARK No. 2  
SANITARY MANHOLE RIM,  
25'± E. OF COMFORT  
STATION.  
ELEVATION: 804.24

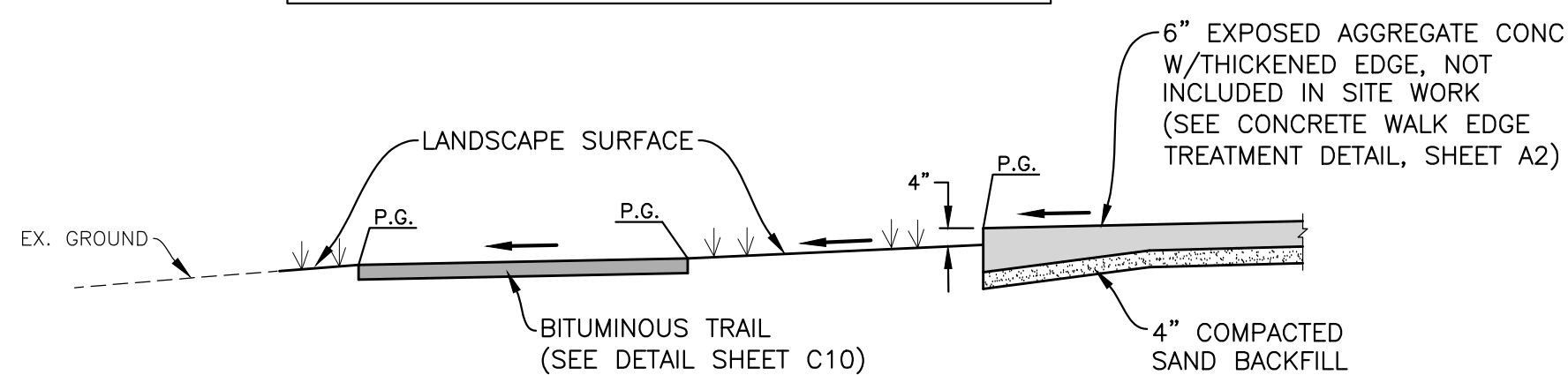
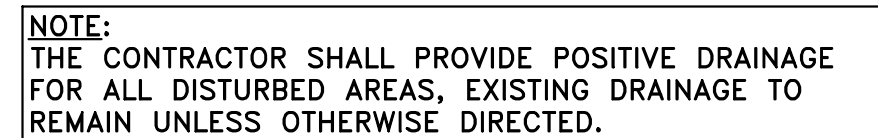

**SECTION A-A**  
NOT TO SCALE

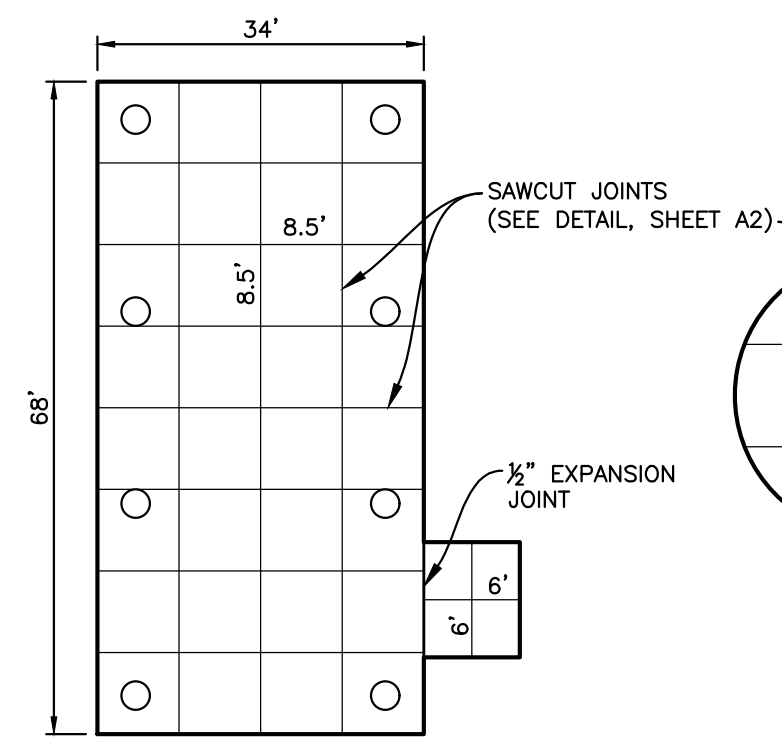

PAVILION JOINTING PLAN

NOT TO SCALE

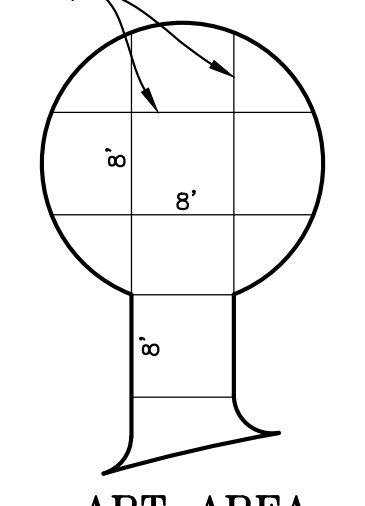

ART AREA  
JOINTING PLAN  
NOT TO SCALE

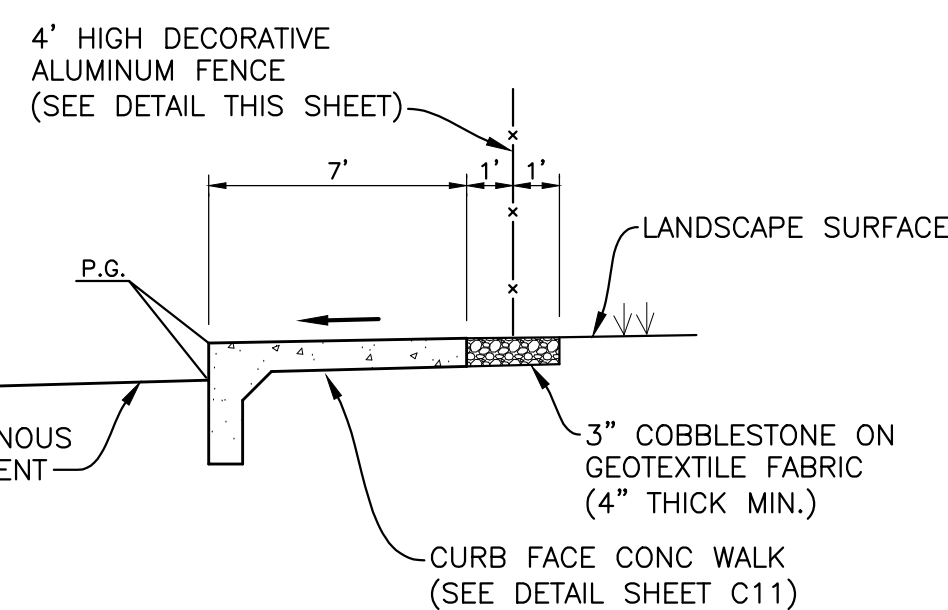

**SECTION B-B**  
NOT TO SCALE

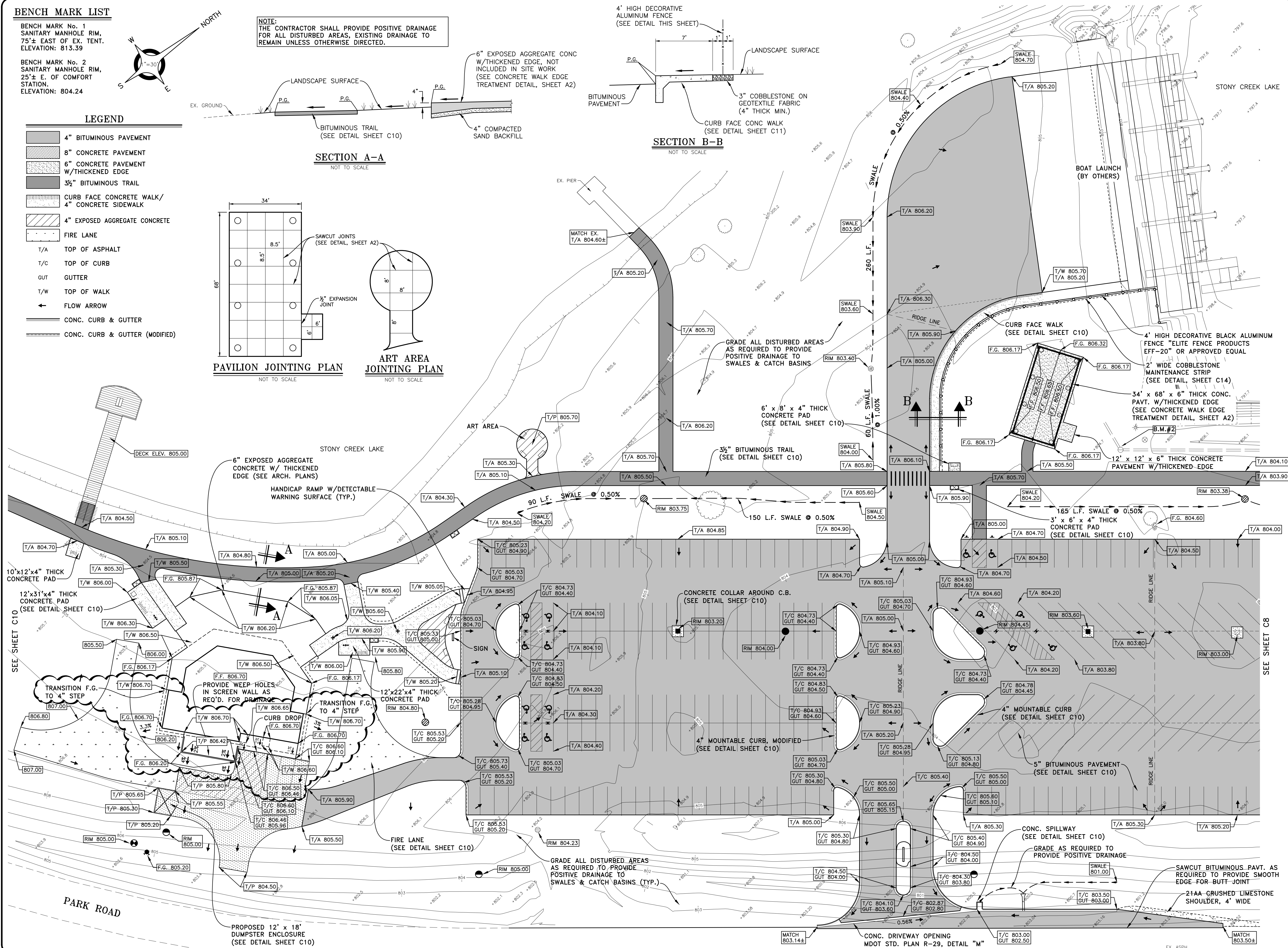

09/18/17	BULLETIN NO. 2
08/08/17	CONSTRUCTION ISSUE
04/25/17	ADDENDUM 2
04/18/17	ADDENDUM 1
04/10/17	BID ISSUE
DATE	SUBMITTALS/REVISIONS

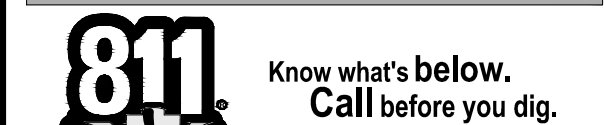

PROJECT NAME:

STONY CREEK  
LANDING

SHEET TITLE:

# PAVING & GRADING PLAN

CLIENT:

HURON CLINTON  
METROPOLITAN AUTHORITY

<input checked="" type="checkbox"/> PRELIMINARY <input checked="" type="checkbox"/> CONSTRUCTION <input type="checkbox"/> RECORD		
DRAWN BY:	CHECKED BY:	DATE:
NAH	CMJ	FEBRUARY 2017

NAH	CMD	FEBRUARY 2017
SCALE:	4" = 30'	

1 = 30

	0	15	30	60
--	---	----	----	----



UTILITY INFORMATION, AS SHOWN, INDICATES APPROXIMATE  
LOADING AND TYPE OF SUPPLY. CAPACITY SHALL BE

LOCATIONS AND TYPES OF EXISTING FACILITIES ONLY, AS  
DISCLOSED BY RECORDS PROVIDED TO THIS FIRM FROM  
THE NATIONAL UTILITY COMPANIES. NO GUARANTEE IS GIVEN

THE VARIOUS UTILITY COMPANIES. NO GUARANTEE IS GIVEN OR IMPLIED AS TO THE COMPLETENESS OR ACCURACY THEREOF.

BEFORE TO CONSTRUCTION. ALL LOCATIONS AND DEPTHS OF

PRIOR TO CONSTRUCTION, ALL LOCATIONS AND DEPTHS OF EXISTING OVERHEAD AND UNDERGROUND UTILITIES (IN CONFLICT WITH THE CONSTRUCTION OF THESE PROPOSED

CONFLICT WITH THE CONSTRUCTION OF THESE PROPOSED IMPROVEMENTS) SHALL BE VERIFIED IN THE FIELD. DURING THE CONSTRUCTION, THE CONTRACTOR SHALL

DURING THE CONSTRUCTION, THE CONTRACTOR SHALL PROTECT AND SUPPORT ALL UTILITIES THAT ARE ENCOUNTERED. (SEE PAGE FOR UTILITY LOCATION)

ENCOUNTERED. (ALL COSTS FOR UTILITY LOCATION VERIFICATION, SUPPORT AND PROTECTION SHALL BE INCLUDED IN THE PROPOSED BAY ITEM CONSISTING WITH

INCLUDED IN THE PROPOSED PAY ITEM CONFLICTING WITH THAT UTILITY).

DURING CONSTRUCTION, THE CONTRACTOR SHALL USE  
EXTREME CAUTION WHEN OPERATING NEAR ANY AND ALL

EXTREME CAUTION WHEN OPERATING NEAR ANY AND ALL  
OVERHEAD AND / OR BURIED UTILITIES.

CALL MISS DIG

PROJECT NO. \_\_\_\_\_

0215-0038

M:\0213\0213-0038\DWG\CIVIL\ENGLANS.DWG  
C09\_grad--9/18/2017 11:26:47 AM

SHEET NO.

CO

0.9

---

COPYRIGHT, 2015, ANDERSON, ECKSTEIN AND WESTRICK, INC.



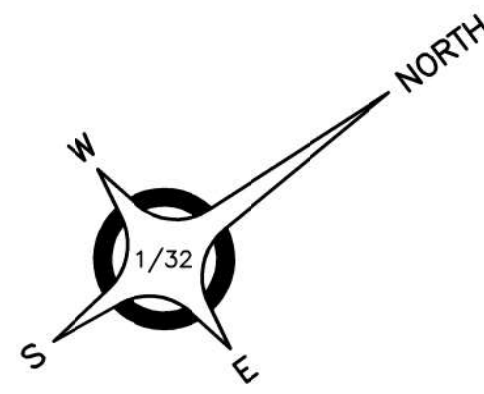

# LEGEND

- SANITARY MANHOLE
- SANITARY SEWER LEAD
- SANITARY LEAD
- FIRE HYDRANT
- GATE VALVE & WELL
- 8" WATER MAIN
- WATER MAIN SERVICE
- FIRE PROTECTION
- STORM CATCH BASIN
- CLEAN OUT
- STORM SEWER
- ARROCK GRANITE TO ROUND OUTDOOR BOLLARD (OR APPROVED EQUAL)
- FLAG POLE LIGHT AND PARK SIGN LIGHT
- ELECTRICAL CONDUIT
- 3-PL 1 (PIER LIGHT) BRISTOL OUTDOOR LIGHTING POST FIXTURE WITH POST ARM, 18 W. LED, 2700K, 120 VOLT

NOTE:  
PROVIDE SEPARATE TIMER AND PHOTOCELL WITH OVERRIDE SWITCH FOR PIER LIGHT CIRCUITS.  
PROVIDE TIMER AND PHOTOCELL CIRCUIT FOR BOLLARD LIGHTING.

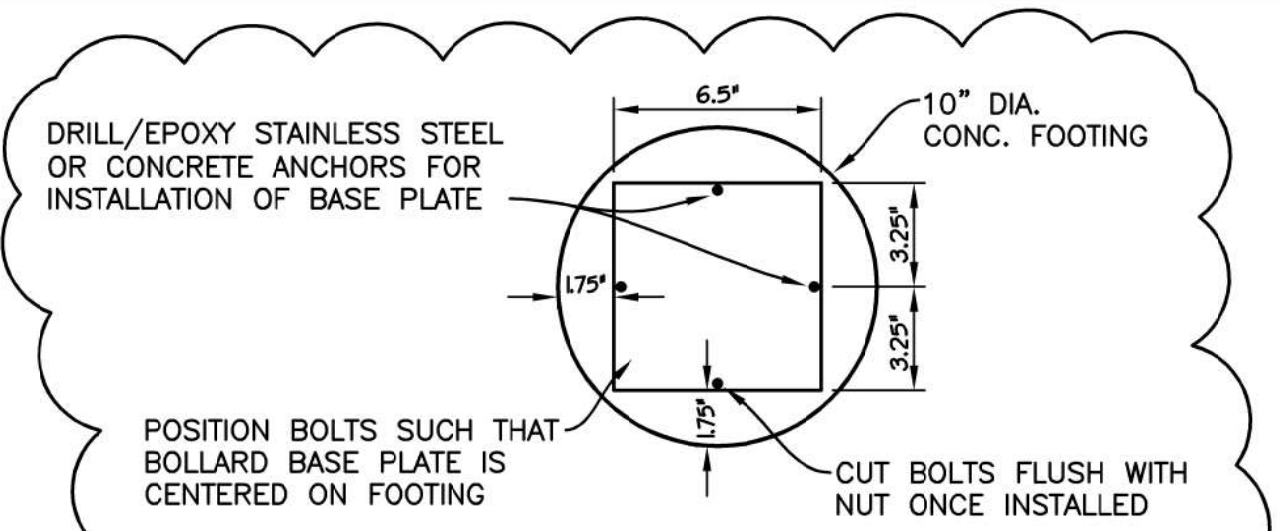

## BOLLARD BASE PLATE BOLT PATTERN

NOT TO SCALE

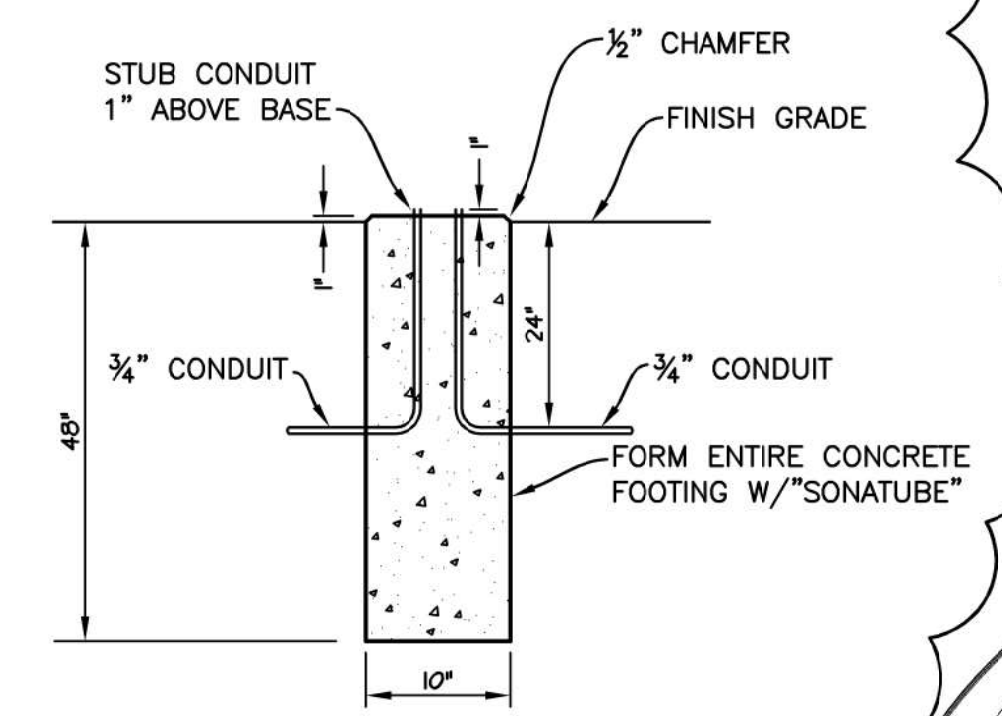

## BOLLARD FOOTING DETAIL

NOT TO SCALE

PROVIDE NEW 125 AMP. CIRCUIT BREAKER PANEL AND PHOTOCONTROL AND TIE TO EXISTING LIGHTING CIRCUITS. ADD DUPLEX RECEPTACLE CIRCUITS AND BREAKERS IN NEW NEMA 3R PANEL MOUNTED INSIDE NEW STRUCTURE.

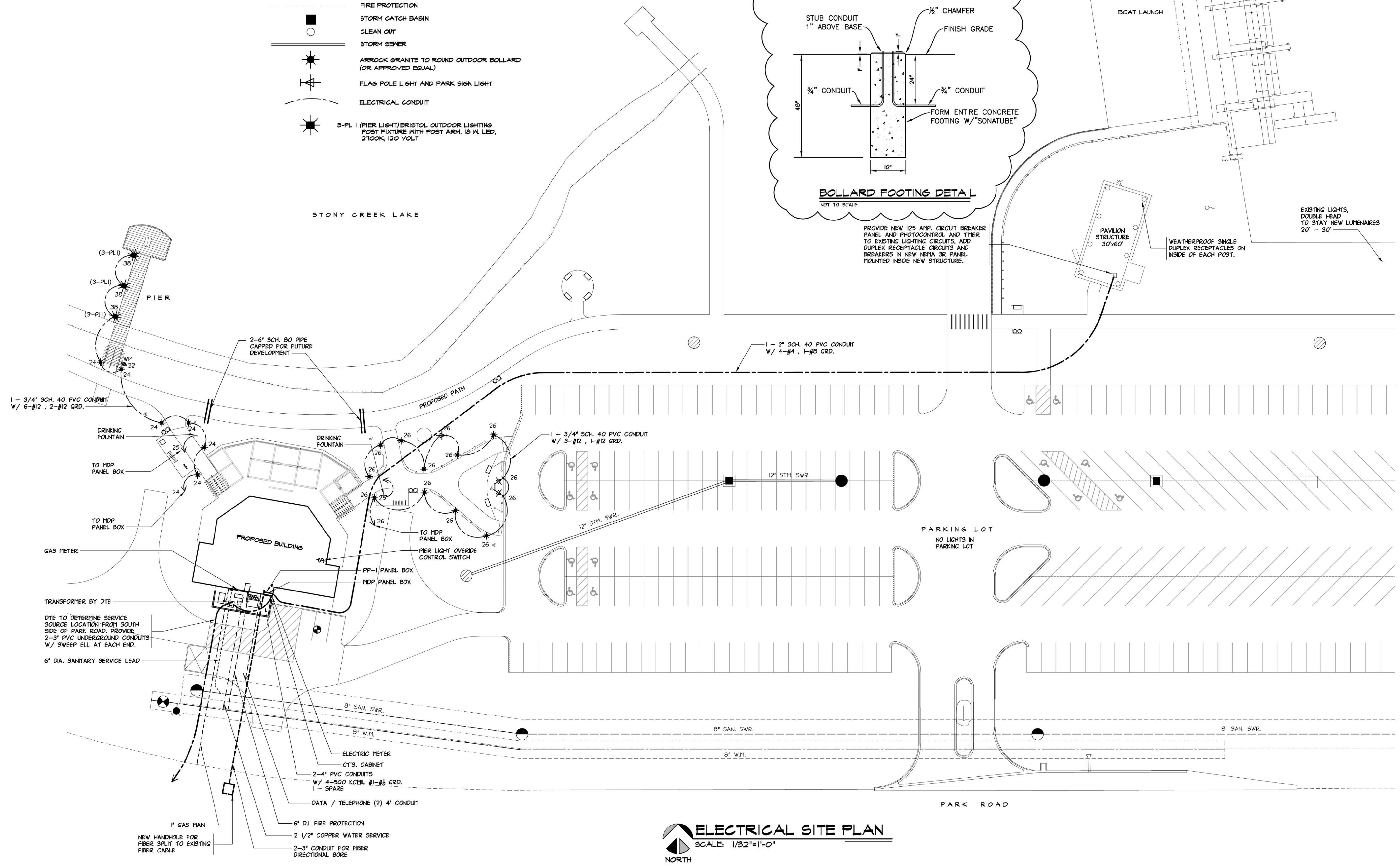

# ELECTRICAL SITE PLAN

SCALE: 1/32"=1'-0"

Civil Engineers  
Surveyors  
Architects

**ANDERSON,  
ECKSTEIN AND  
WESTRICK, INC.**

51301 Schoenherr Road  
Shelby Township  
Michigan 48315

Phone 586 726 1234  
Fax 586 726 8780  
www.aewinc.com

DATE	SUBMITTALS/REVISIONS
09/18/17	BULLETIN NO. 2
08/08/17	CONSTRUCTION ISSUE
04/25/17	ADDENDUM 2
04/18/17	ADDENDUM 1
04/10/17	BID ISSUE
03/31/17	HMA PLAN REVIEW
03/16/17	PERMIT ISSUE

3 WORKING DAYS  
BEFORE YOU DIG  
CALL MISS DIG  
811  
(TOLL FREE)

PROJECT NAME:

## STONY CREEK LANDING

SHEET TITLE:

## ELECTRICAL SITE PLAN

CLIENT: HURON-CLINTON METROPOLITAN AUTHORITY		
<input checked="" type="checkbox"/> PRELIMINARY	<input checked="" type="checkbox"/> CONSTRUCTION	<input type="checkbox"/> RECORD
DRAWN BY: BLC	CHECKED BY: JRA	DATE: NOVEMBER 2016
SCALE: AS NOTED		

UTILITY INFORMATION, AS SHOWN, INDICATES APPROXIMATE LOCATIONS AND TYPES OF EXISTING FACILITIES ONLY, AS DISCLOSED BY RECORDS PROVIDED TO THIS FIRM FROM THE VARIOUS UTILITY COMPANIES. NO GUARANTEE IS GIVEN OR IMPLIED AS TO THE COMPLETENESS OR ACCURACY THEREOF.

PRIOR TO CONSTRUCTION, ALL LOCATIONS AND DEPTHS OF EXISTING OVERHEAD AND UNDERGROUND UTILITIES (IN CONFLICT WITH THE CONSTRUCTION OF THESE PROPOSED IMPROVEMENTS) SHALL BE VERIFIED IN THE FIELD. DURING THE CONSTRUCTION, THE CONTRACTOR SHALL PROTECT AND SUPPORT ALL UTILITIES THAT ARE ENCOUNTERED. (ALL COSTS FOR UTILITY LOCATION VERIFICATION, SUPPORT AND PROTECTION SHALL BE INCLUDED IN THE PROPOSED PAY ITEM CONFLICTING WITH THAT UTILITY.)

DURING CONSTRUCTION, THE CONTRACTOR SHALL USE EXTREME CAUTION WHEN OPERATING NEAR ANY AND ALL OVERHEAD AND / OR BURIED UTILITIES.

CALL MISS DIG

PROJECT NO. 0215-0038

M:\0215\0215-0038\DWG\ARCH\0215-0038.DWG  
24X35--9/18/2017 10:57:09 AM

SHEET NO.

EO